

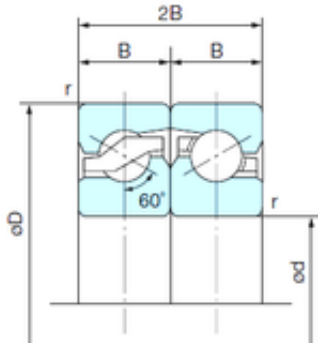

Tnb industrial Partners Manufacturing...

30 mm x 62 mm x 15 mm NACHI 30TAB06DF Cojinetes De Bola



Bearing No. 30TAB06DF

30TAB06DF Bearing 2D drawings and 3D CAD models

Size	30x62x15 mm
Bore Diameter	30 mm
Outer Diameter	62 mm
Width	15 mm
d	30 mm
D	62 mm
B	15 mm
C	15 mm
Angle (°)	60 °
r min.	1 mm
r1 min.	0.6 mm
2B	30 mm
Weight	0.21 Kg
Basic dynamic load rating (C)	29,9 kN
Basic static load rating (C0)	46,4 kN
Bore Type	Cylindrical Bore
Enclosure	Open
Configuration	Double Row
Bore Size	30 mm
Outside Diameter	62 mm
Width	15 mm
Fillet Radius/Chamfer	1 mm
r1	0.6 mm
Dynamic Load Rating	29,900 N
Static Load Rating	46,400 N



Tnb industrial Partners Manufacturing...

Limiting Speed - Grease	4,650 rpm
Limiting Speed - Oil	6,000 rpm
Starting Torque - Grease Lubrication	20 N · cm
da1 (min)	46.2 mm
da2 (min)	39.7 mm
Da1 (max)	46 mm
Da2 (max)	53.4 mm